

Seas to Trees Template 1

A color version of this template is available at www.newchurch.org/youth-journey-programs.

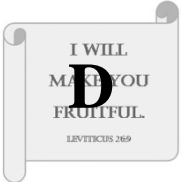

Part A

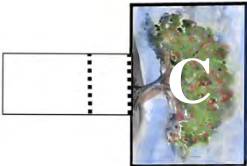
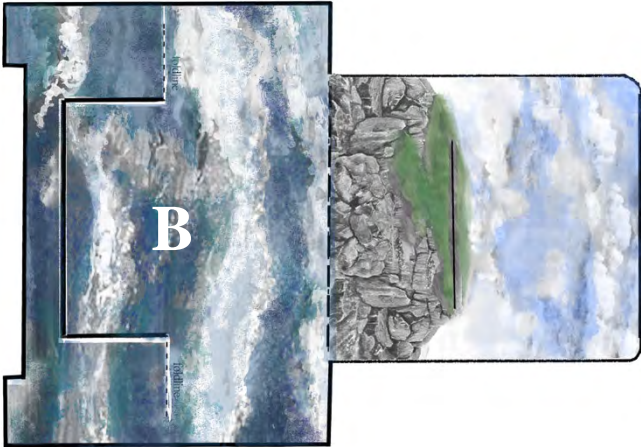
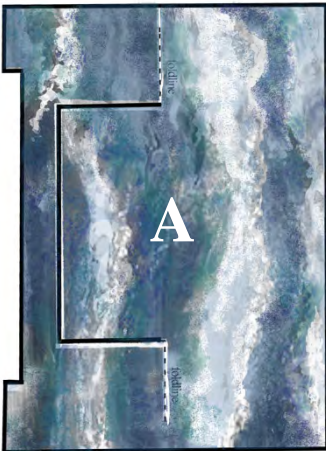
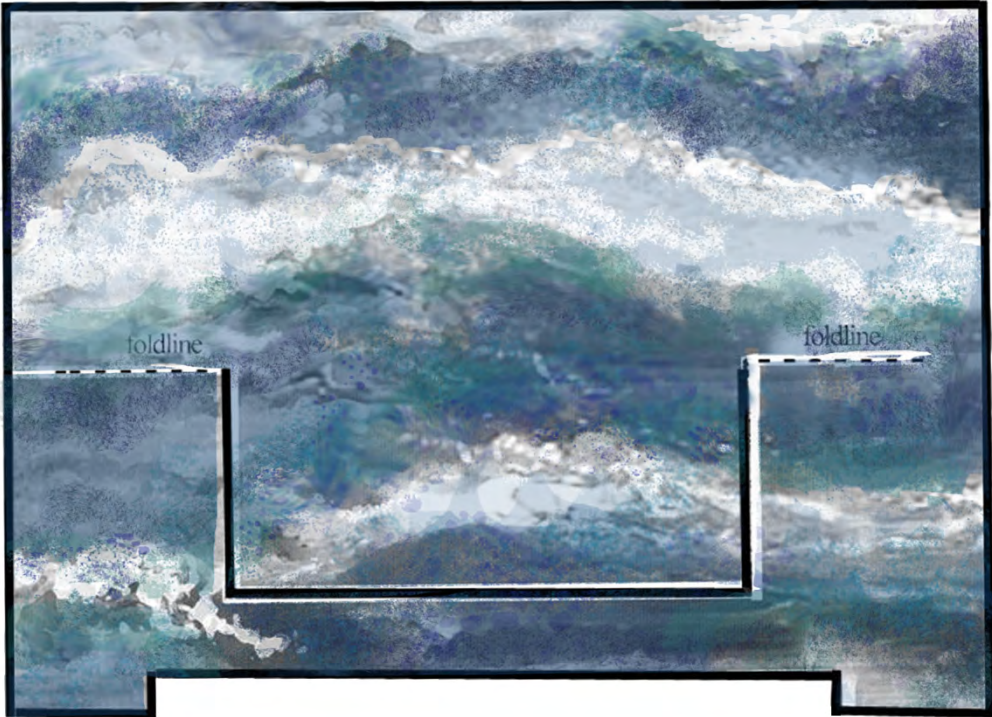

Seas to Trees Template 2

A color version of this template is available at www.newchurch.org/youth-journey-programs.

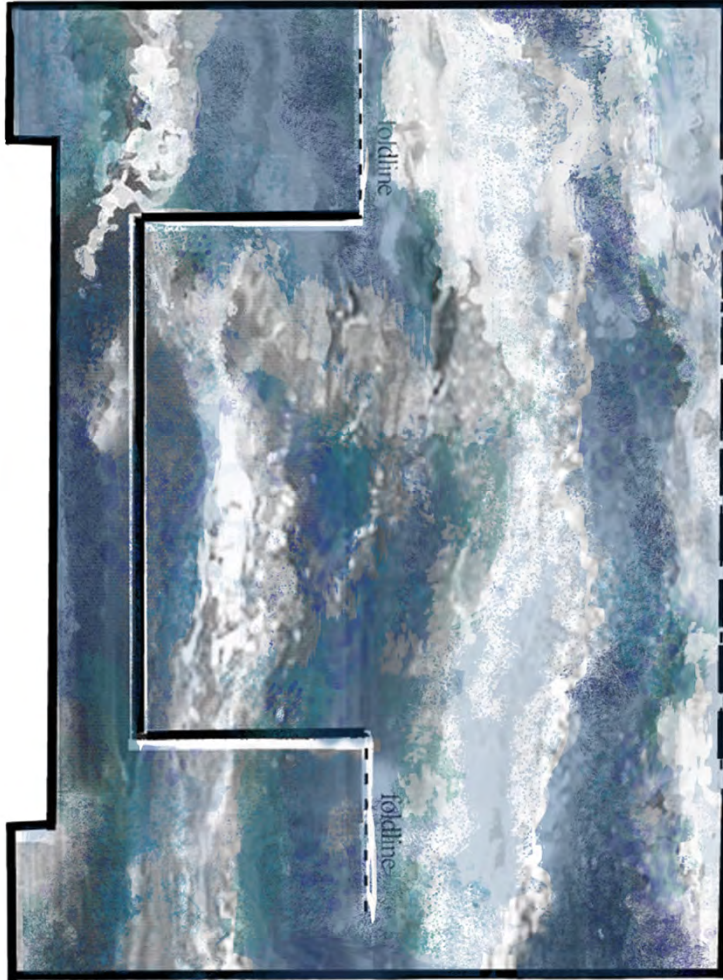

Part B

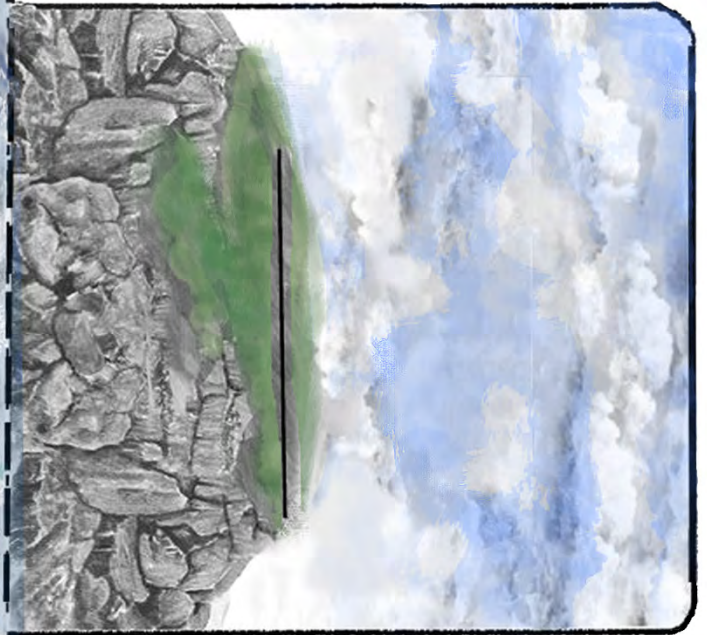

Part C

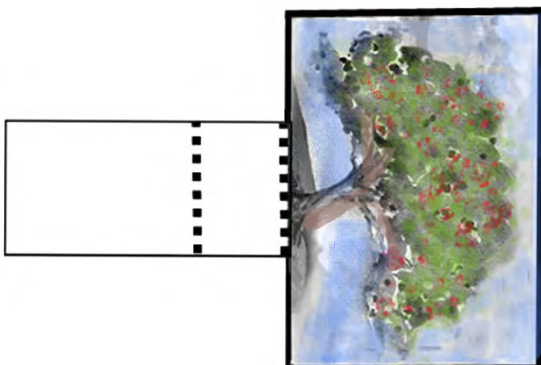

Part D

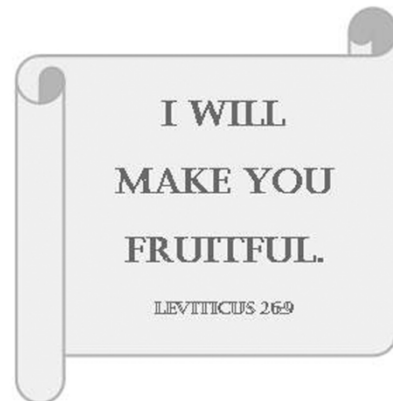

Seas to Trees Pop-up Assembly Photo Directions

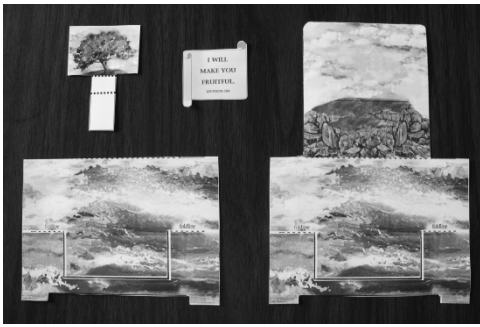

1. Cut out parts A, B, C and D.

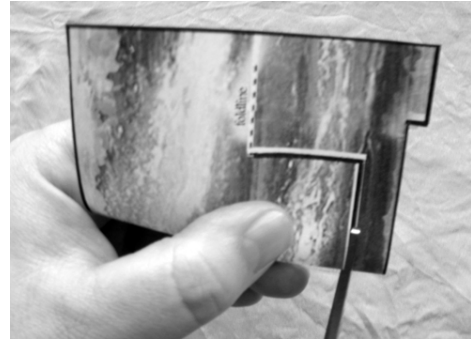

2. Gently bend part A in the center and make a small cut along the solid black line as shown.

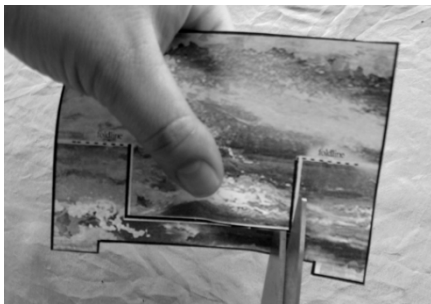

3. Flatten A and cut along all the solid black lines.

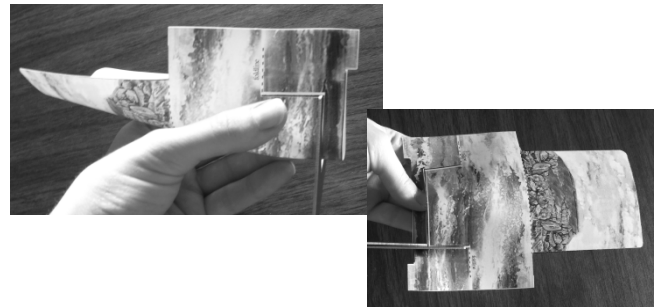

4. Repeat steps 2 & 3 with part B.

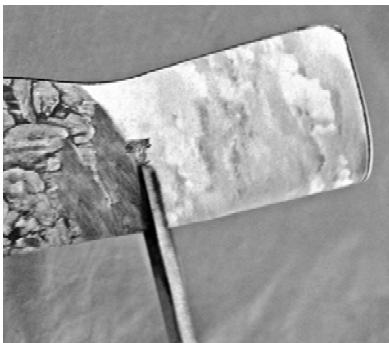

5. Gently bend the "island" on part B in half and cut along the solid black line.



6. Fold the "island" up along the fold line so the pictures are back to back, facing away from each other.

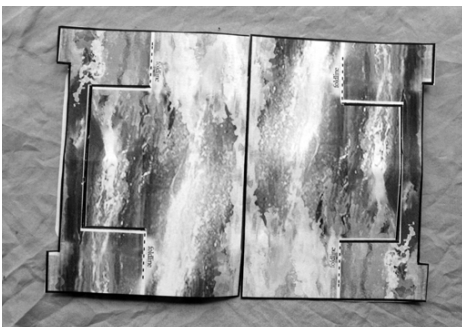

7. Line up parts A and B with the "seas" showing and the "island" tucked underneath in the center.



8. Tape parts A and B together along the middle line.

Seas to Trees Pop-up Assembly Directions continued

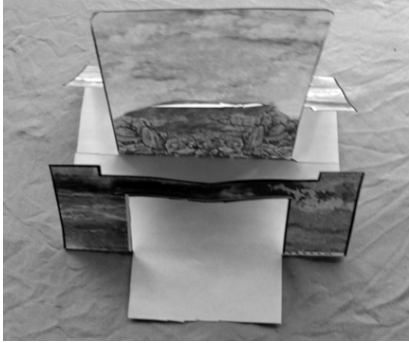

9. Turn the project over. Fold parts A and B upwards along the middle fold lines.



10. Bend the folded parts until they meet. Tape across the tabs on either side of the project. Do not tape the "island".

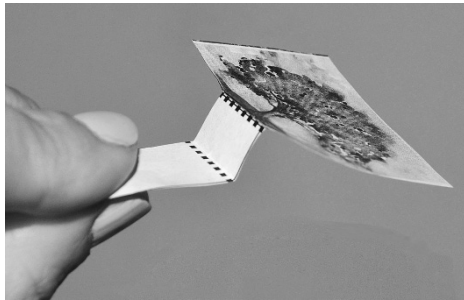

11. Fold part C (tree tab) on the dotted lines in "accordion fashion" as shown.

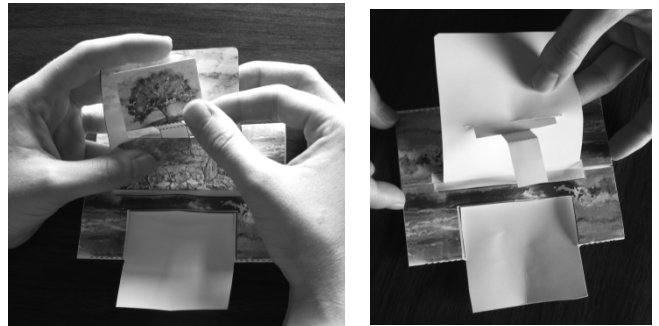

12. Insert part C through the slit on the island. (Shown from front and back.)



13. Secure the tree by taping the tab of the tree down, below the island fold line.



14. Tape part D (quote) to the flap in front of the "island" pop-up.

Seas to Trees Pop-up Manipulation Directions

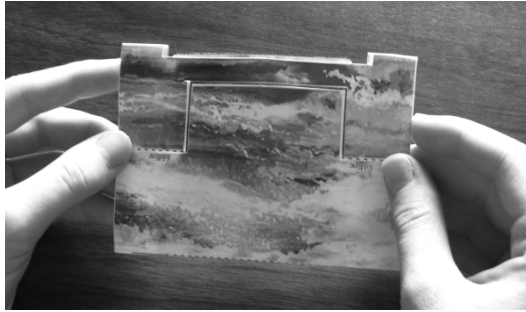

1. Close the project up so you can only see the seas.

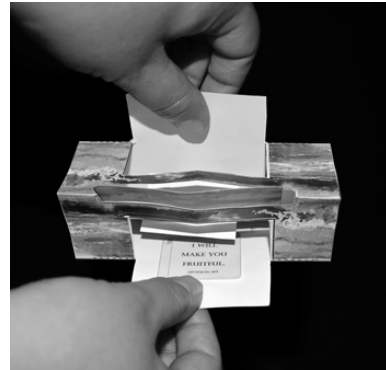

2. Pull the tabs on either side as shown. (View from above.)



3. (View of the same step from the front.) The land will pop up, and the top of the tree will be visible through the slit above the island.



4. Pull up the tree.



5. Seas to Trees pop-up completed. Can be re-folded and popped up again and again.